

1 Monday Trash 1-29-20

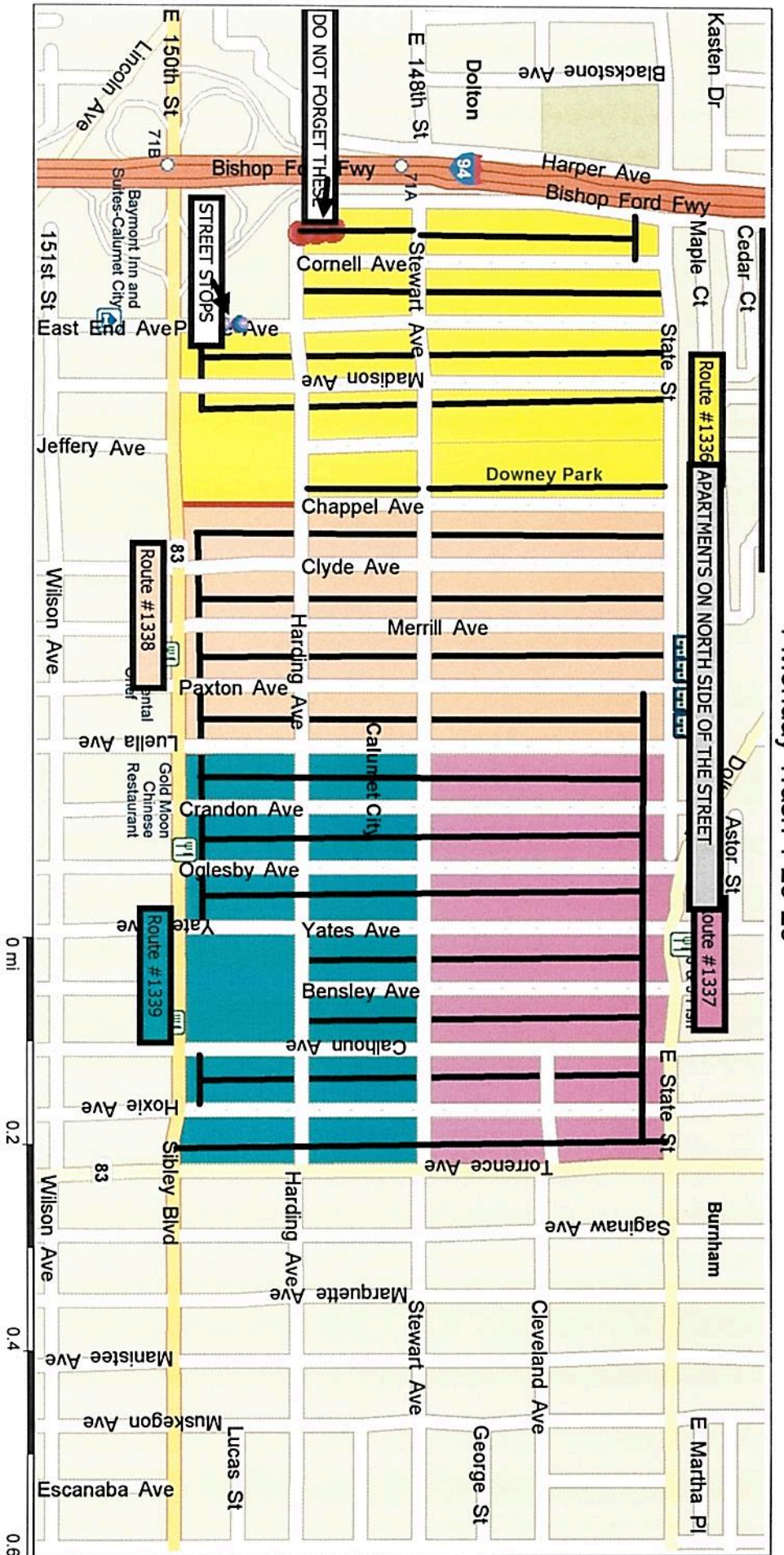

2 Tuesday Trash 1-29-20

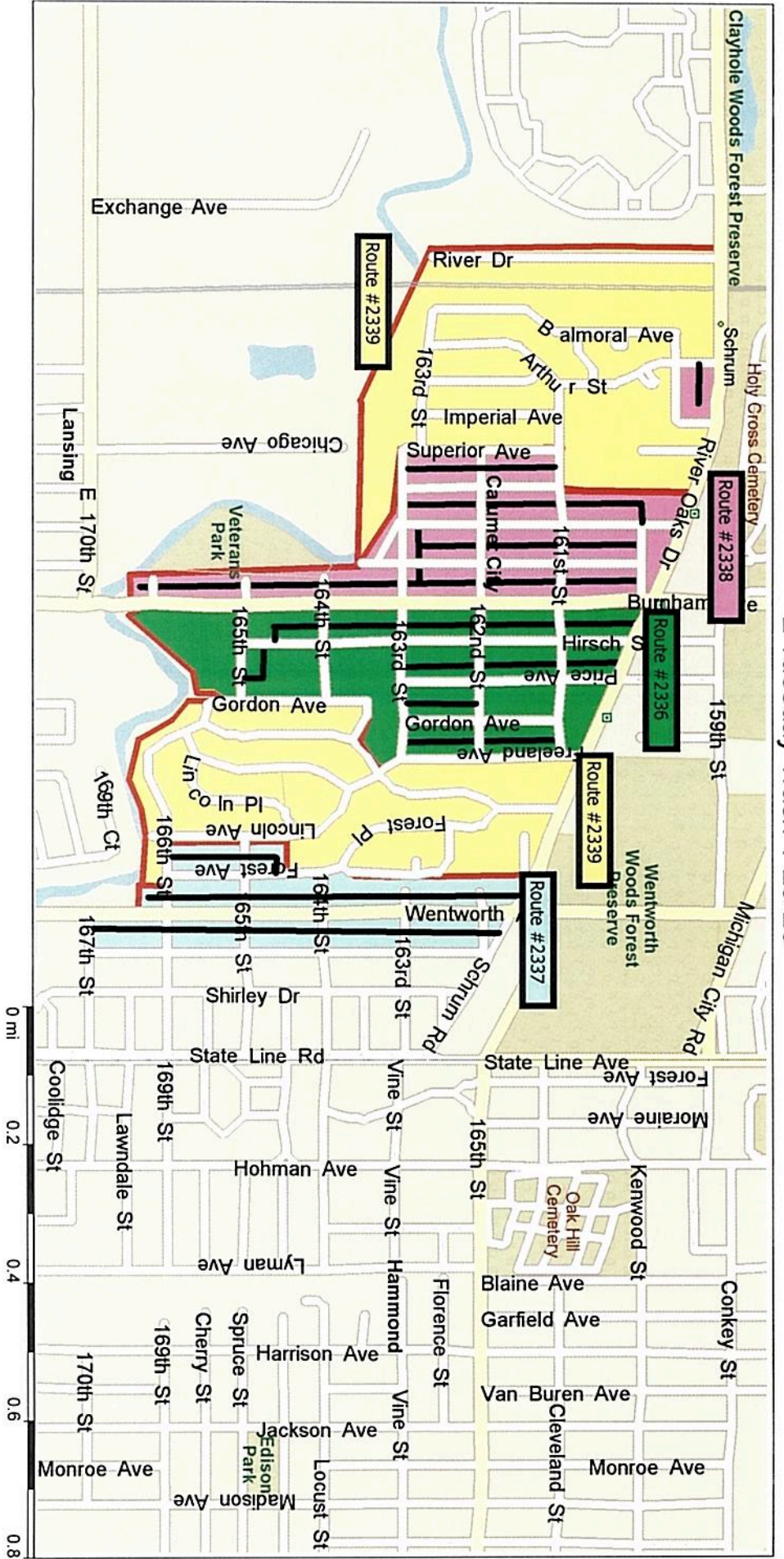

Copyright © and (P) 1998–2009 Microsoft Corporation and/or its suppliers. All rights reserved. <http://www.microsoft.com/street/>
Certain mapping and direction data © 2009 NAVTEQ. All rights reserved. The Data for areas of Canada includes information taken with permission from Canada authorities, including © Her Majesty the Queen in Right of Canada © Queen's Printer for Ontario NAVTEQ and NAVTEQ ON BOARD are trademarks of NAVTEQ. © 2009 TeleAtlas North America, Inc. All rights reserved. TeleAtlas and TeleAtlas North America are trademarks of TeleAtlas, Inc. © 2009 by Applied Geographic Systems. All rights reserved.

3 Wednesday Trash 1-29-20

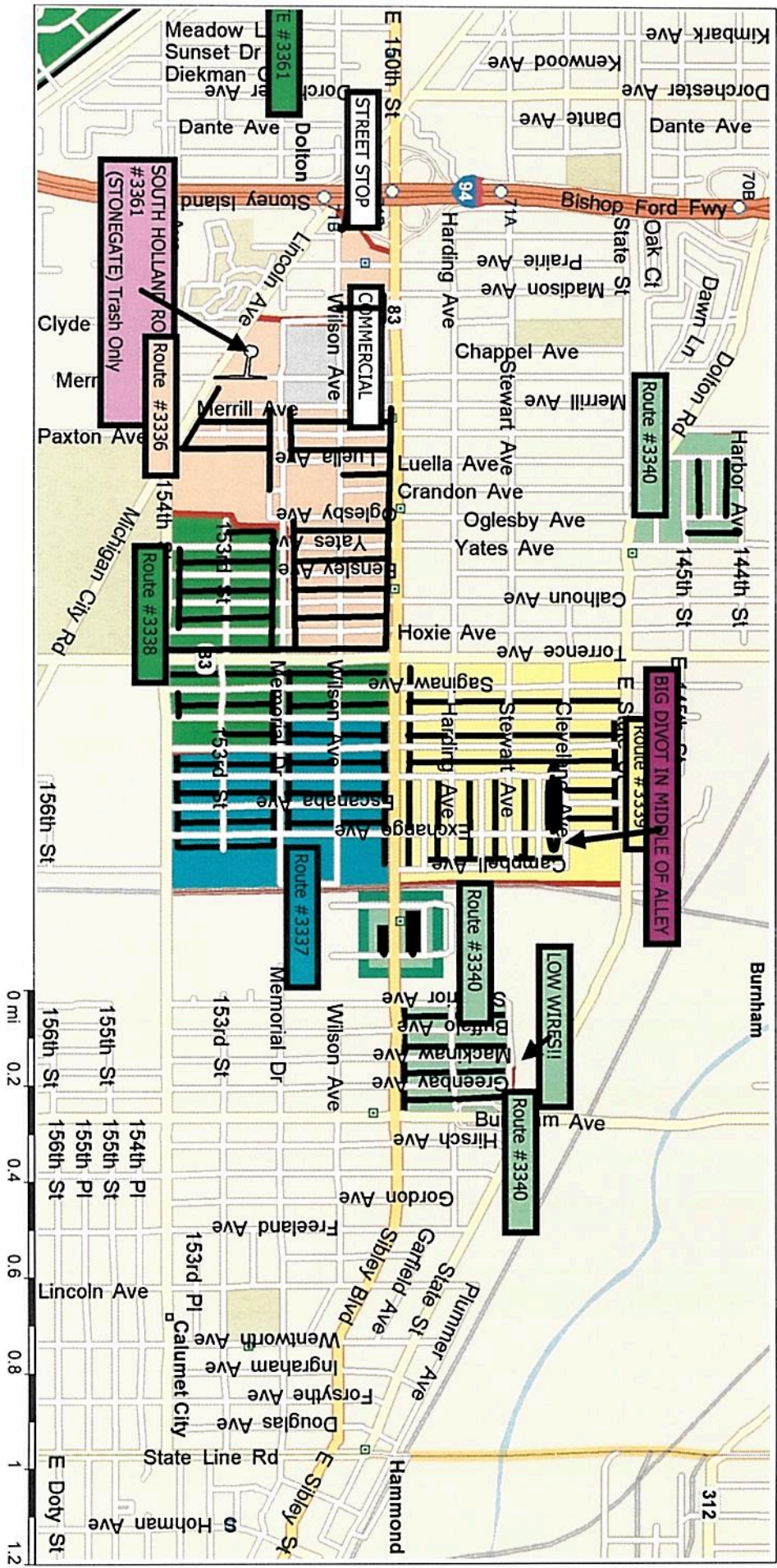

Copyright © and (P) 1998-2009 Microsoft Corporation and/or its suppliers. All rights reserved. [http://www.microsoft.com/street/](http://www.microsoft.com/street)
 Certain mapping and direction data © 2009 NAVTEQ. All rights reserved. The Data for areas of Canada includes information taken with permission from Canada authorities, including © Her Majesty the Queen in Right of Canada © Queen's Printer for Ontario. NAVTEQ and NAVTEQ ON BOARD are trademarks of NAVTEQ. © 2009 Tele Atlas North America. All rights reserved. Tele Atlas and Tele Atlas North America are trademarks of Tele Atlas, Inc. © 2009 by Applied Geographic Systems. All rights reserved.

4 Thursday Trash 1-31-20

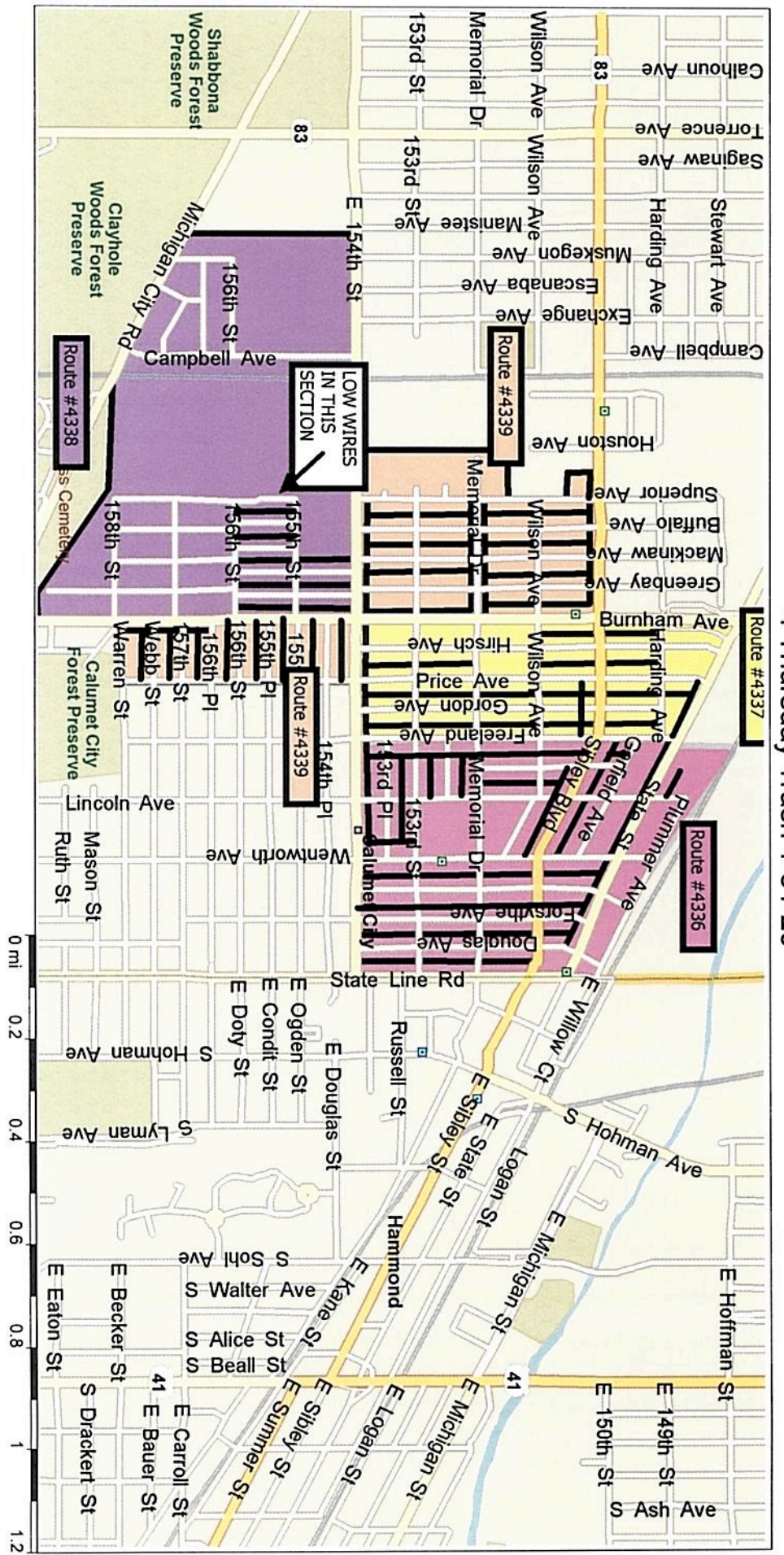

Copyright © and (P) 1998-2009 Microsoft Corporation and/or its suppliers. All rights reserved. <http://www.microsoft.com/streets/>
 Certain mapping and direction data © 2009 NAVTEQ. All rights reserved. The Data for areas of Canada includes information taken with permission from Canadian authorities, including © Her Majesty the Queen in Right of Canada © Queen's Printer for Ontario. NAVTEQ and NAVTEQ ON BOARD are trademarks of NAVTEQ. © 2009 Tele Atlas North America, Inc. All rights reserved. Tele Atlas and Tele Atlas North America are trademarks of Tele Atlas, Inc. © 2009 by Applied Geographic Systems. All rights reserved.

5 Friday Trash 1-31-20

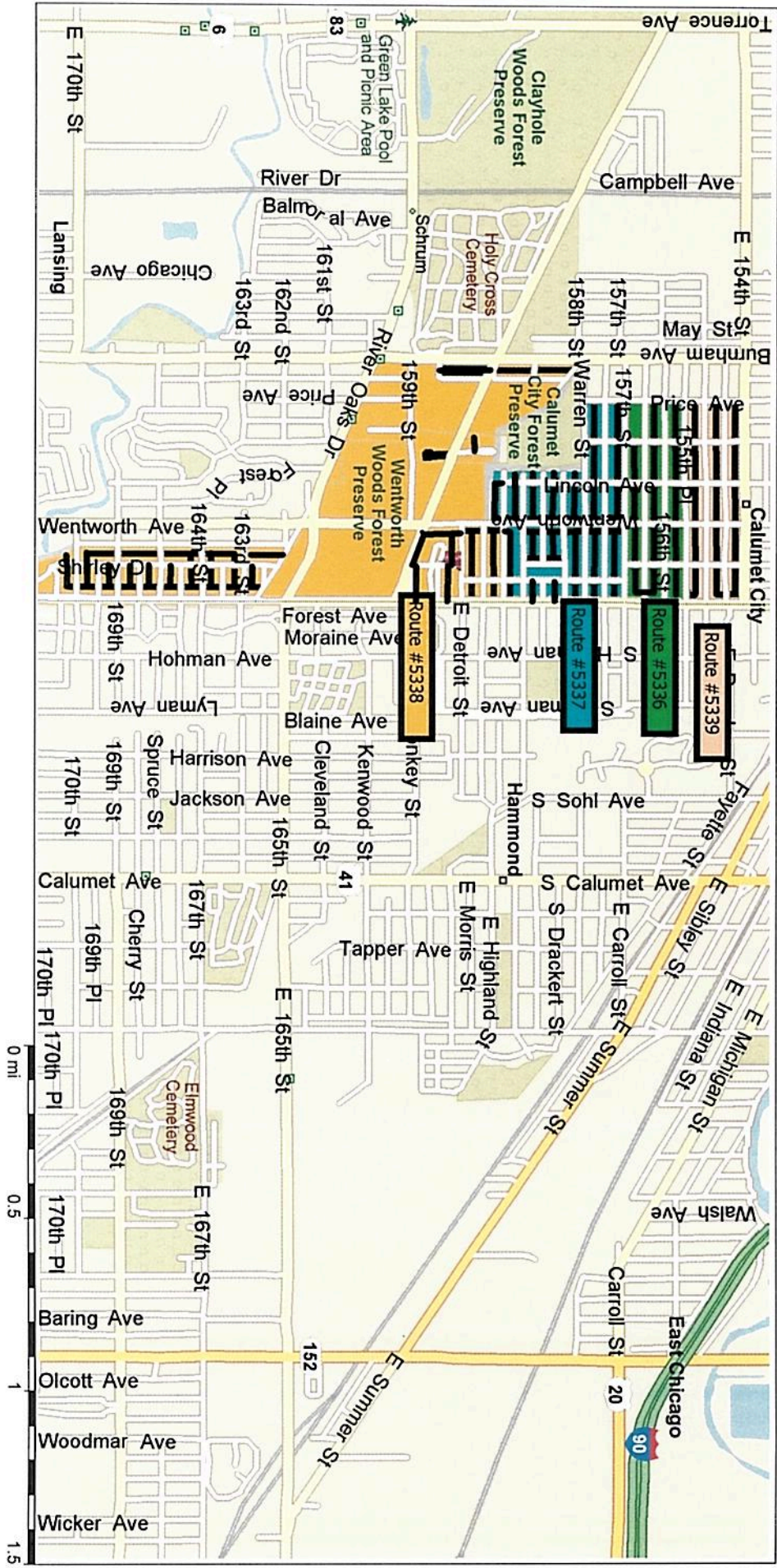

Copyright © and (P), 1989-2009 Microsoft Corporation and/or its suppliers. All rights reserved. <http://www.microsoft.com/street/>
 Certain mapping and direction data © 2009 NAVTEQ. All rights reserved. The Data for areas of Canada includes information taken with permission from Canadian authorities, including © Her Majesty the Queen in Right of Canada © Queen's Printer for Ontario. NAVTEQ and NAVTEQ ON BOARD are trademarks of NAVTEQ. © 2009 Tele Atlas North America, Inc. All rights reserved. Tele Atlas and Tele Atlas North America are trademarks of Tele Atlas, Inc. © 2009 by Applied Geographic Systems. All rights reserved.

Monday recycling 1-29-20

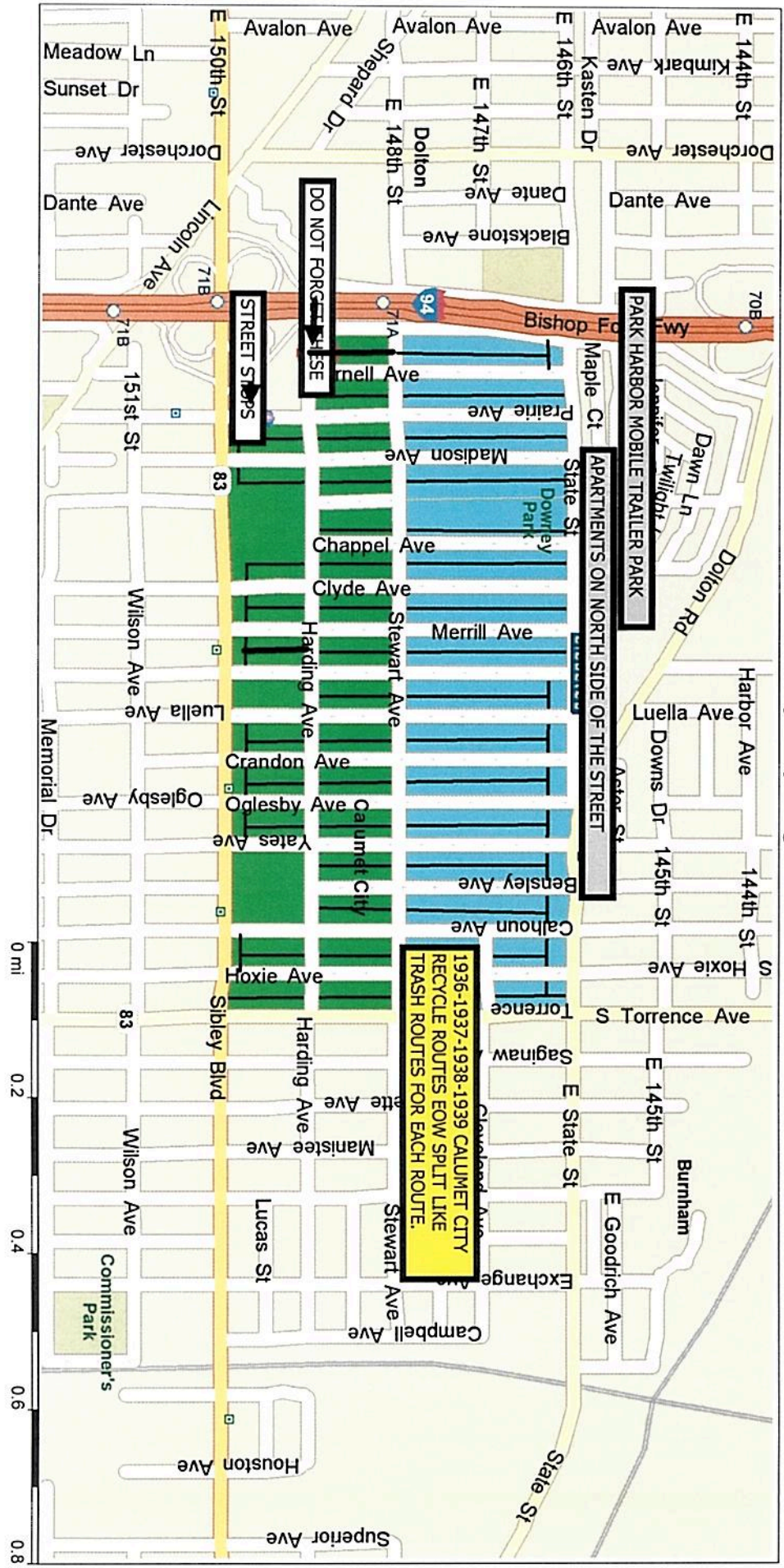

Copyright © and (P) 1988-2009 Microsoft Corporation and/or its suppliers. All rights reserved. <http://www.microsoft.com/streets/>
 Certain mapping and direction data © 2009 NAVTEQ. All rights reserved. The Data for areas of Canada includes information taken with permission from Canadian authorities, including © Her Majesty the Queen in Right of Canada © Queen's Printer for Ontario NAVTEQ and NAVTEQ ON BOARD are trademarks of NAVTEQ. © 2009 Tele Atlas North America, Inc. All rights reserved. Tele Atlas and Tele Atlas North America are trademarks of Tele Atlas, Inc. © 2009 by Applied Geographic Systems. All rights reserved.

Tuesday Recycling 1-31-20

BOTH BLUE AND GREEN WEEKS ARE SPLIT UP BETWEEN ROUTE #S: 2936,2937,2938. #2939 ALL STREET WORK.

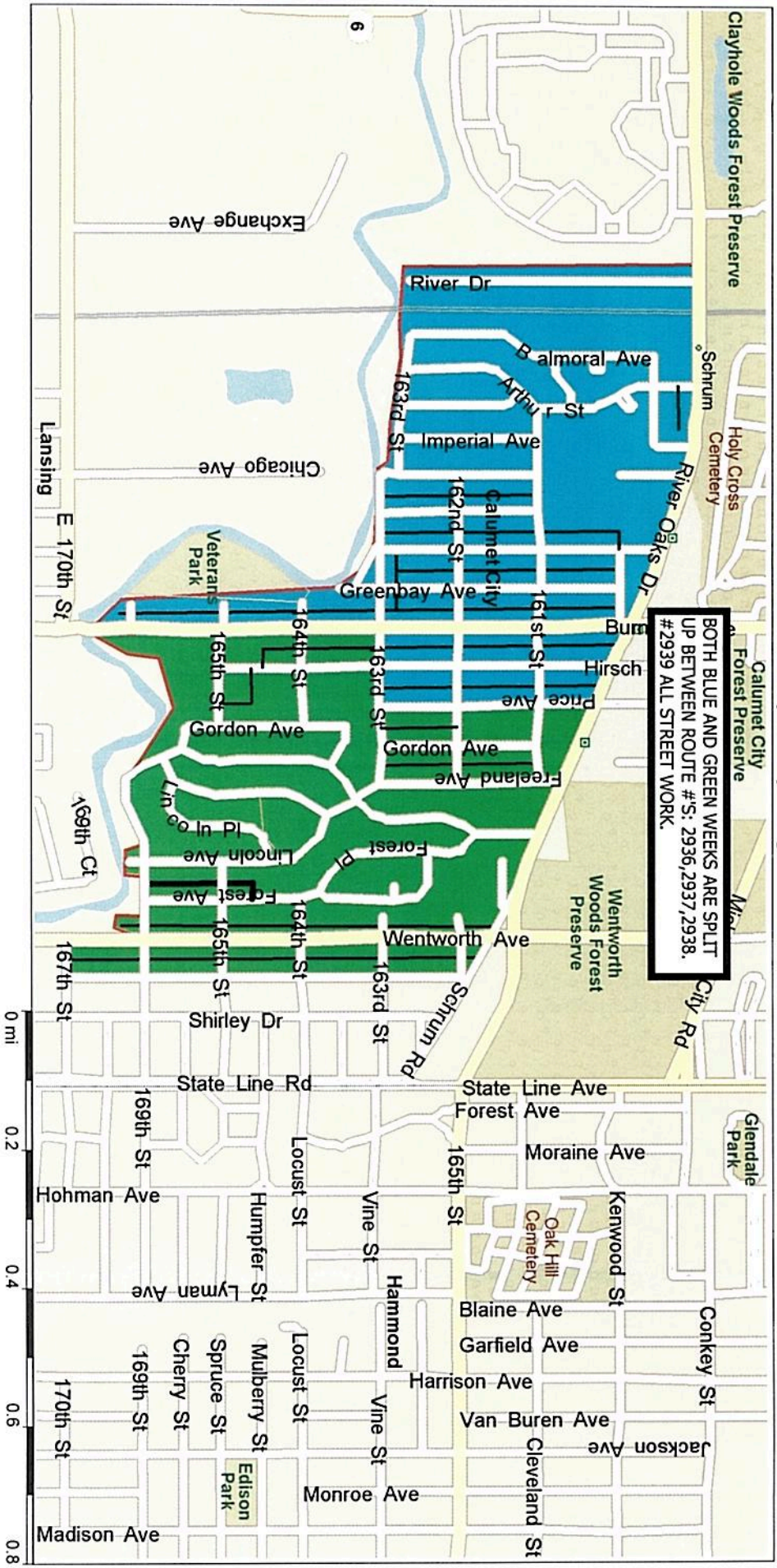

Copyright © and (P) 1998-2009 Microsoft Corporation and/or its suppliers. All rights reserved. <http://www.microsoft.com/street/>
 Certain mapping and direction data © 2009 NAVTEQ. All rights reserved. The Data for areas of Canada includes information taken with permission from Canada authorities, including © Her Majesty the Queen in Right of Canada © Queen's Printer for Ontario. NAVTEQ and NAVTEQ ON BOARD are trademarks of NAVTEQ. © 2009 Tele Atlas North America, Inc. All rights reserved. Tele Atlas and Tele Atlas are trademarks of Tele Atlas. Inc. © 2009 by Applied Geographic Systems. All rights reserved.

Wednesday Recycling 1-31-20

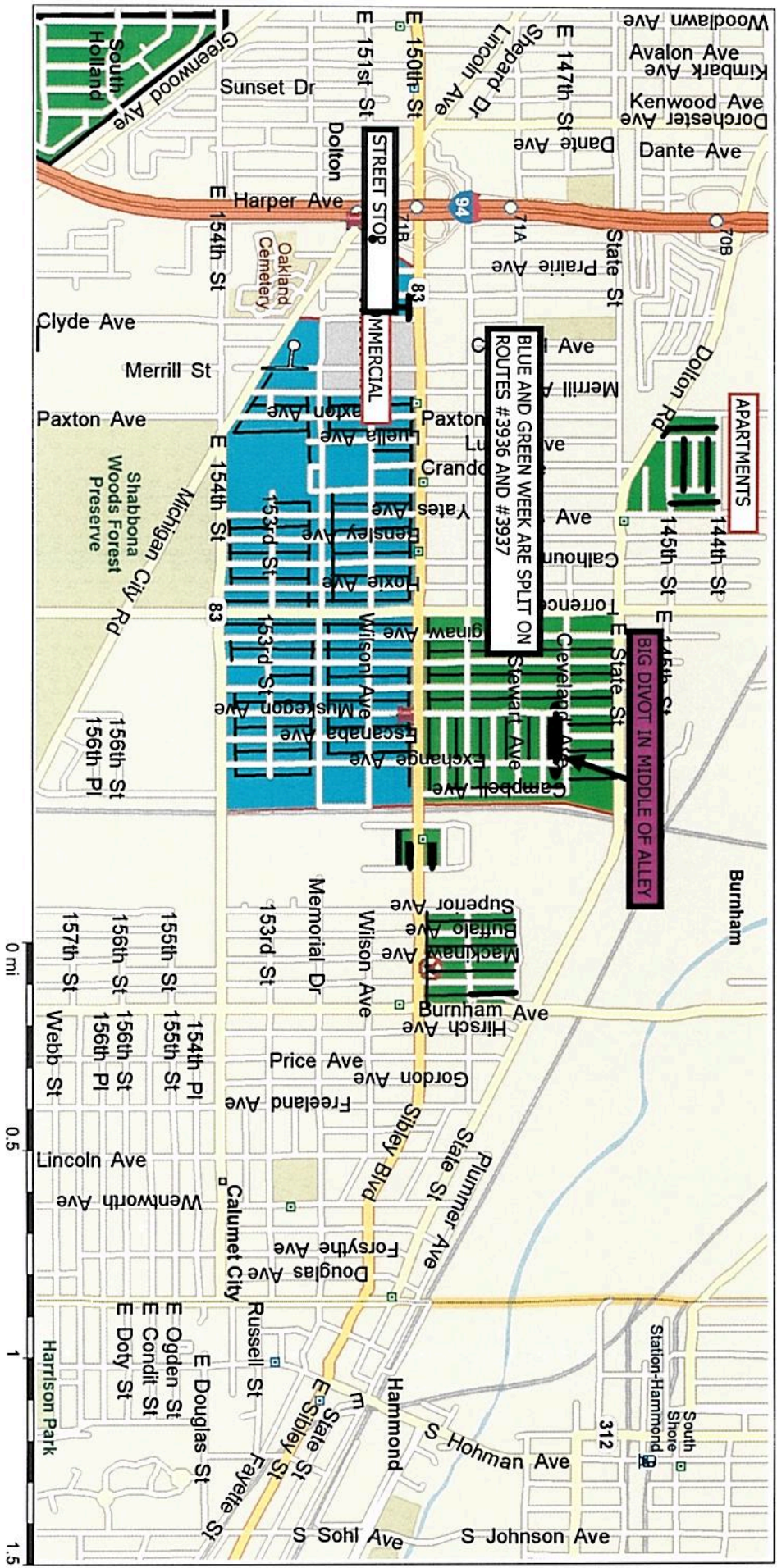

Copyright © and (P) 1998-2009 Microsoft Corporation and/or its suppliers. All rights reserved. [http://www.microsoft.com/street/](http://www.microsoft.com/street)
 Certain mapping and direction data © 2009 NAVTEQ. All rights reserved. The Data for areas of Canada includes information taken with permission from Canada's authorities, including © Her Majesty the Queen in Right of Canada © Queen's Printer for Ontario NAVTEQ and NAVTEQ ON BOARD are trademarks of NAVTEQ. © 2009 Tele Atlas North America, Inc. All rights reserved. Tele Atlas and Tele Atlas are trademarks of Tele Atlas, Inc. © 2009 by Applied Geographic Systems. All rights reserved.

Thursday Recycling 1-31-20

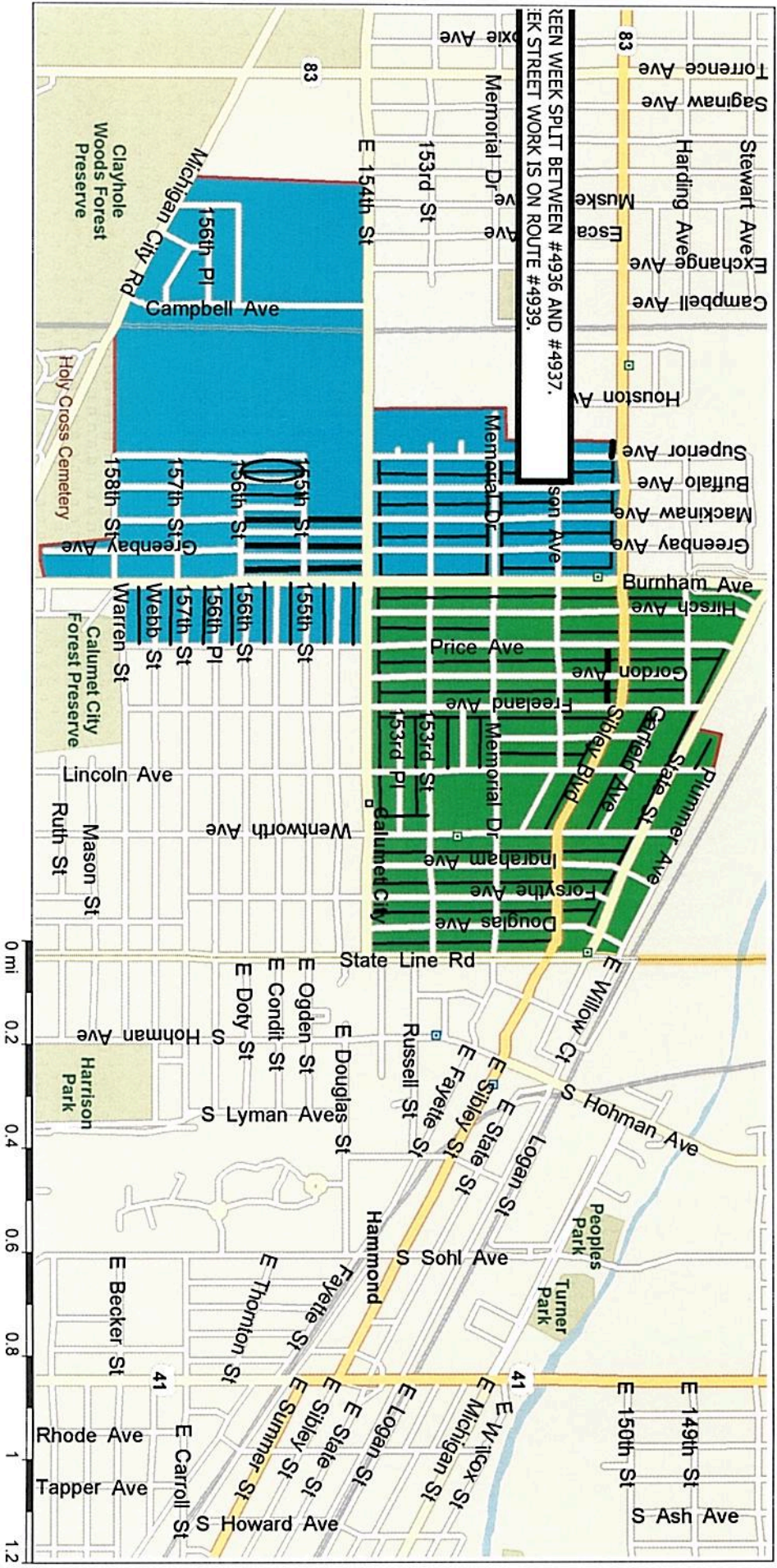

Copyright © and (P) 1988-2009 Microsoft Corporation and/or its suppliers. All rights reserved. <http://www.microsoft.com/streets/>
 Certain mapping and direction data © 2009 NAVTEQ. All rights reserved. The Data for areas of Canada includes information taken with permission from Canada authorities, including © Her Majesty the Queen in Right of Canada © Queen's Printer for Ontario, NAVTEQ and NAVTEQ ON BOARD are trademarks of NAVTEQ. © 2009 Tele Atlas North America, Inc. All rights reserved. Tele Atlas and Tele Atlas North America are trademarks of Tele Atlas, Inc. © 2009 by Applied Geographic Systems. All rights reserved.

Friday Recycling 1-31-20

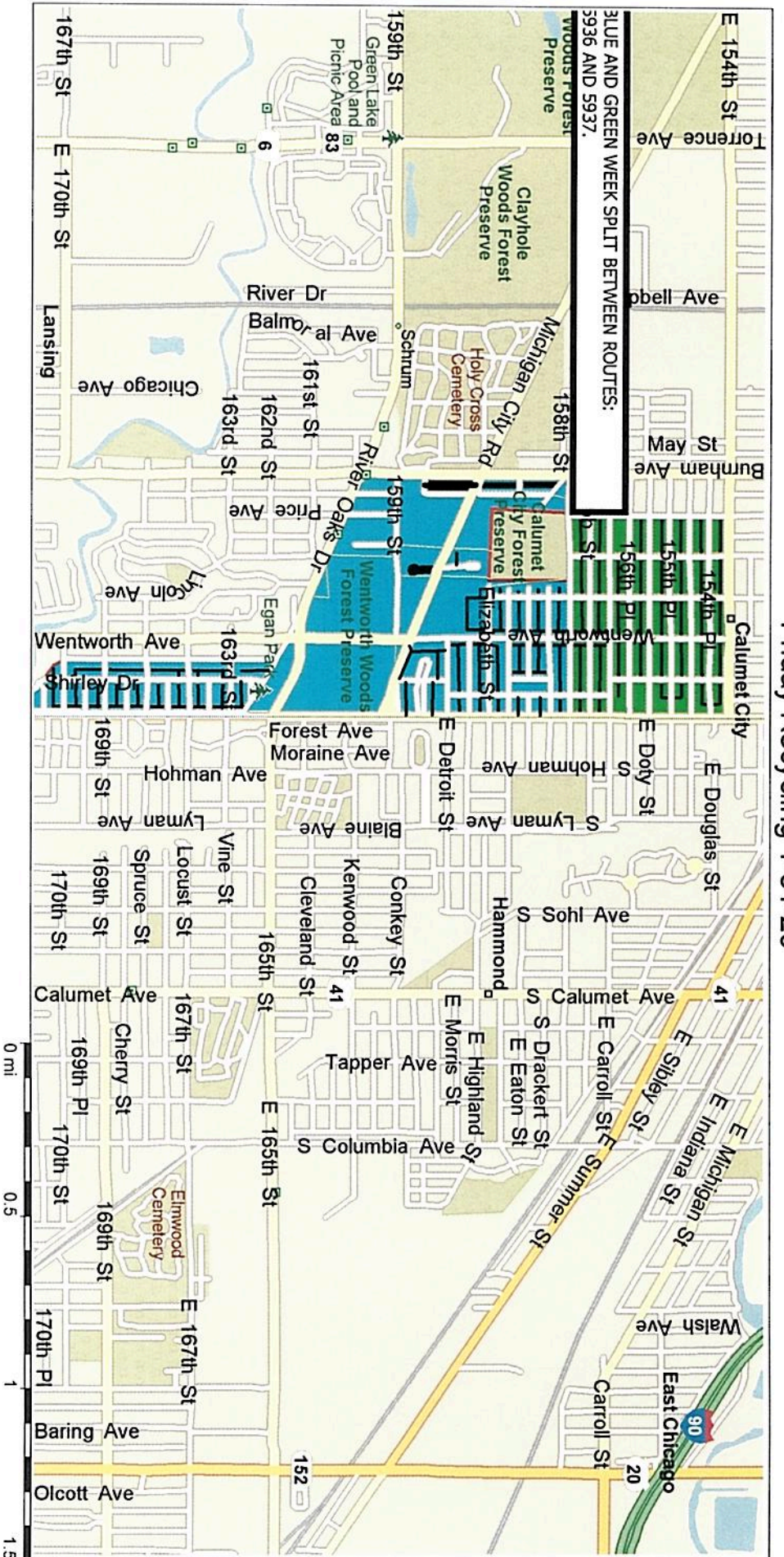

BLUE AND GREEN WEEK SPLIT BETWEEN ROUTES:
5936 AND 5937.

